



**PHOENIX  
222C**



0.2 mm Nozzle

6 cc Cup

Double Action

Eyelet Needle Cap

Air Volume Adjuster

Pre-set adjustment handle



### DANGER

- ◆ Never use a spray gun near a source of fire or flame
- ◆ Never use a spray gun in close proximity to children.
- ◆ Never use/aim a spray gun aiming at a person



### WARNING

- ◆ Never use a spray gun near foods with care for ventilation.
- ◆ The sharp tip of the needle is dangerous, take care when handling.
- ◆ Spray with air only, Never with other gases (e.g. Nitrogen, Hydrogen, or Carbon Dioxide).



### CAUTION

- ◆ Make sure to put the lid on airbrush so as not to spill painting.
- ◆ Clean an airbrush soon after painting to prevent solidify inside spray gun.
- ◆ Make sure to stop air supply when disassembling a spray gun or removing air hose.
- ◆ Take much care for needle tip if you paint without air cap.

#### Air Supplying

- Air compressor is necessary for airbrush.
- Using a compressor with an air regulator is highly recommended to get sufficient spraying quality.
- Operates on air 0.1MPa (14psi) to 0.3MPa (43psi).
- Fine adjustment of air volume is available with 222C Finger Lever and Air Volume Adjuster.

#### Painting with airbrush

1. 222C is double action airbrush. Firstly put diluted paint in cup, Secondly push Finger Lever with forefinger or thumb, and air will be blown, Thirdly pull Finger Lever backward, Volume of air and liquid is adjustable with handling of Finger Lever.
2. More you pull Finger Lever, Bigger spray pattern you can get. Use Masking tape when you need sharp line.
3. When you get small spray pattern, close airbrush to object.
4. Pre-set adjustment handle is used for spraying a certain amount of paint. Pre-set adjustment handle stop the move of needle, and you can always spray the same amount of paint.

## PHOENIX 222C Parts List

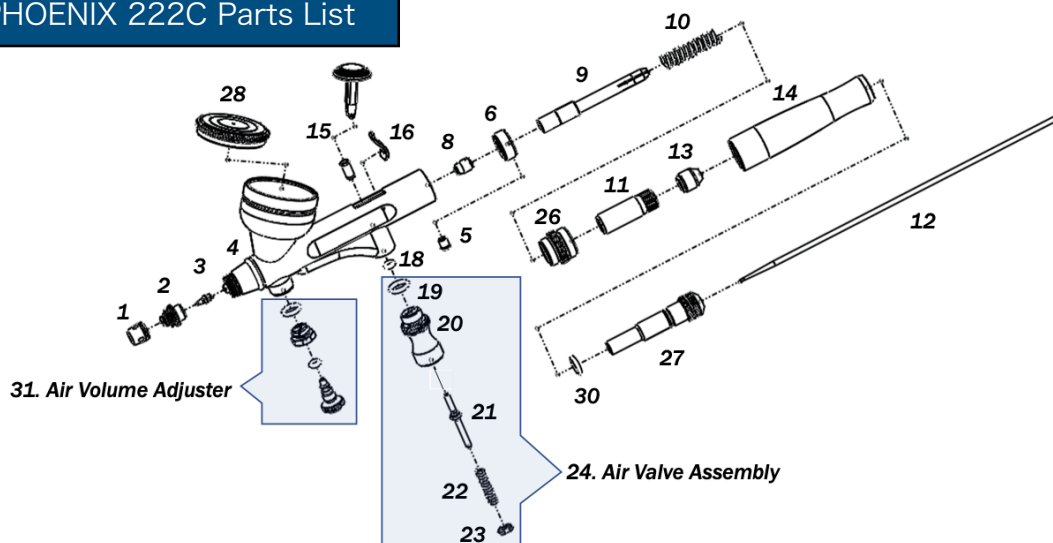

No.	Part	Code
1	Needle Cap	29768
2	Nozzle Cap	29769
3	Nozzle	29770
4	Body	---
5	Screw/Stop	29771
6	Guide-Screw	29772
8	Teflon Packing Set	29807
9	Needle Support	---
10	Needle Spring	29776
11	Spring Screw	29777
12	Needle	29778
13	Needle Locknut	29779
14	Handle	29780
15	Finger Lever (Assembled)	29781

No.	Part	Code
16	Back Lever	29782
18	O-Ring/Shift Pin	29783
19	O-Ring 5.41x1.02	29838
20	Valve Body	29717
21	Valve Plunger (with O-Ring)	29718
22	Valve Spring	29719
23	Valve Washer	29720
24	Air Valve Assembly	29721
26	Bush	29790
27	Needle Adjuster (with O-Ring)	29791
28	Lid for 222C	---
30	O-Ring 5.0x1.0 (Assembled)	---
31	Air Volume Adjuster	---



When you clean airbrush.  
Loose #2 Nozzle Cap and spray.  
And air will flow back to a cup.

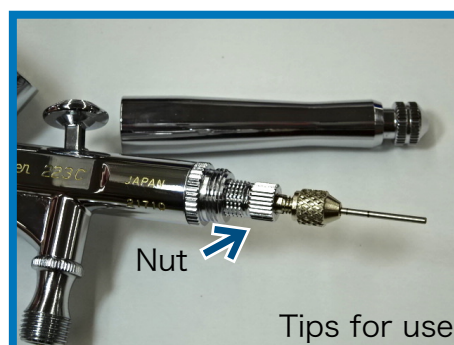

You can adjust the touch of  
#15 Finger Lever with this Nut.

## Contact

**Fuso Seiki Co.,Ltd.**

Tokyo, Japan

<https://www.fusoseiki.co.jp>